

## Metallic elastic hard sealing butterfly valve

<sup>3</sup>  
Dt 643H-<sup>16</sup>  
<sub>9</sub> 25 C.P.R.V

Flang type elastic metallic hard sealing butterfly valve

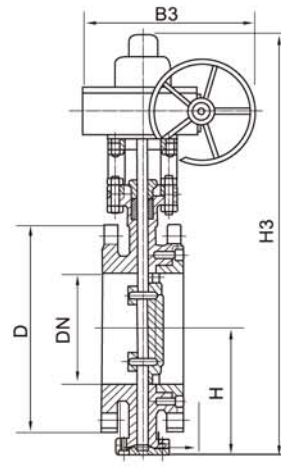
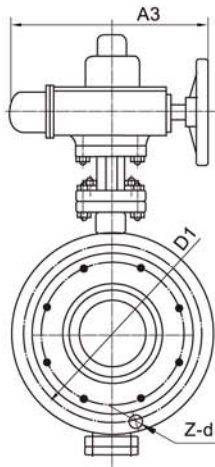

Dt943<sup>H</sup><sub>F</sub>

DN Nominal diameter		Structure length (standard)		H	External dimension (consult)									Connection dimension (standard)						
Mm	Inch	L			Dt343H			Dt643H			Dt943H			PN1. 6MPa			PN2. 5MPa			Dt343H (kg)
		Brief	Long		H1	A1	B1	H2	A2	B2	H3	A3	B3	D	D1	Z-d	D	D1	Z-d	
50	2	108	150	112	350	180	200	605	245	72	530	250	255	165	125	4-18	165	125	4-18	19
65	2 1/2	112	170	115	370	180	200	625	245	72	530	250	255	185	145	4-18	185	145	8-18	22
80	3	114	180	120	380	180	200	645	355	92	565	250	255	200	160	8-18	200	160	8-18	25
100	4	127	190	138	420	180	200	675	355	92	600	250	255	220	180	8-18	235	190	8-22	28
125	5	140	200	164	460	180	200	715	355	92	640	250	255	250	210	8-18	270	220	8-26	43
150	6	140	210	175	555	270	280	800	250	138	705	300	315	285	240	8-22	300	250	8-26	50
200	8	152	230	208	605	270	280	850	250	170	775	300	315	340	295	12-22	360	310	12-26	64
250	10	165	250	243	680	270	280	925	250	170	945	300	315	405	355	12-26	425	370	12-30	99
300	12	178	270	283	800	380	420	1035	450	220	1070	300	315	460	410	12-26	485	430	16-30	130
350	14	190	290	310	835	380	420	1070	450	220	1140	300	315	520	470	16-26	555	490	16-33	188
400	16	216	310	340	915	450	470	1190	650	220	1210	300	315	580	525	16-30	620	550	16-36	270
450	18	222	330	380	960	450	470	1250	650	280	1335	575	714	640	585	20-30	670	600	20-36	350
500	20	229	350	410	1020	480	490	1290	850	280	1415	575	714	715	650	20-33	730	660	20-36	375
600	24	267	390	470	1225	640	660	1455	850	380	1605	656	714	840	770	20-36	845	770	20-39	560
700	28	292	430	550	1355	640	660	1585	1250	380	1844	656	810	910	840	24-36	960	875	24-42	610
800	32	318	470	640	1470	640	660	1700	1250	280	2040	656	810	1025	950	24-39	1085	990	24-48	880
900	36	330	510	710	1545	650	860	1865	1250	280	2255	785	863	1125	1050	28-39	1185	1090	28-48	1100
1000	40	410	550	770	1795	650	900	2015	1250	380	2380	785	863	1255	1170	28-42	1320	1210	28-56	1600
1200	48	470	630	890	1965	650	900	2226	1500	380	2640	785	863	1485	1390	32-48	1530	1420	32-56	2150

User's attention: Dimension of H1, H2, H3 in form can lengthen (long stem butterfly valve) according to customer's requirements, this product according to short series generally, if need long series or special material should be mentioned while ordering.

Annotate: Dt-Expresses the structure of spring seal